

# The Central Campus Recreational Building (CCRB), Kinesiology Building, and Annex

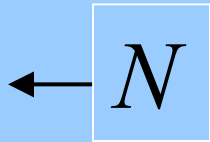

Annex  
1327 Geddes Ave.  
(view looking north)



**CCRB "bridge" or "north" Entrance**

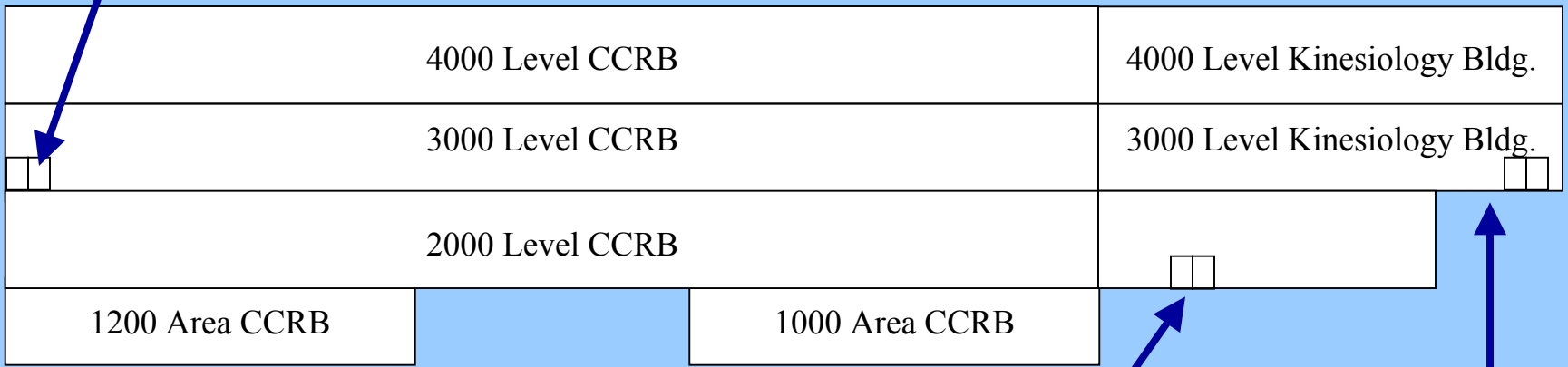

West Elevation

**"Bell Pool" Entrance**

**Kinesiology Building  
"Geddes" or "south" Entrance**

# Offices

## 1000 Level (south basement) CCRB

Back to Start



Annex

4000 CCRB	4000 Kinesiology
3000 CCRB	3000 Kinesiology
2000 CCRB	Bell Pool
1200	1000

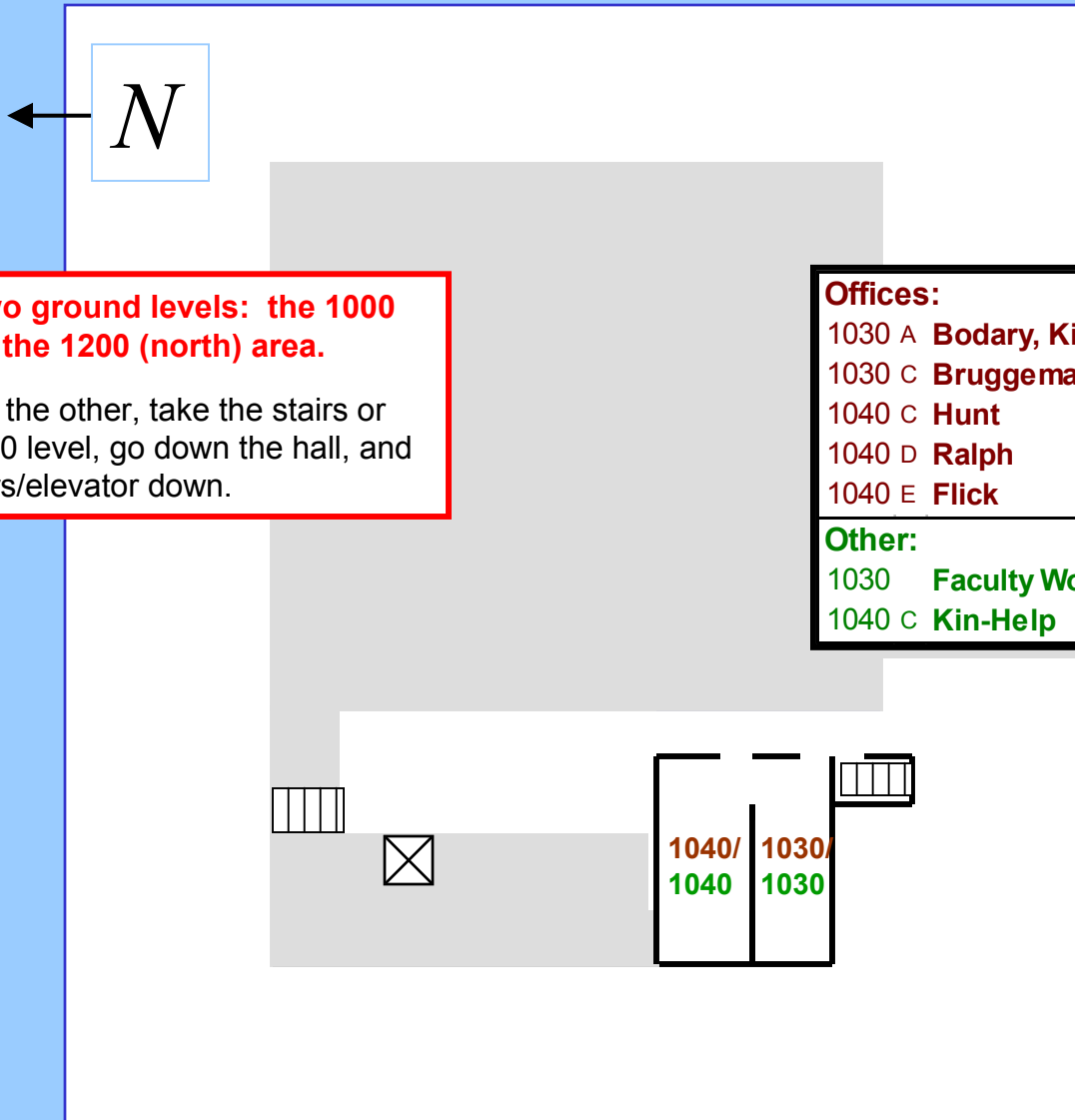

**The CCRB has two ground levels: the 1000 (south) area, and the 1200 (north) area.**

To get from one to the other, take the stairs or elevator to the 2000 level, go down the hall, and take the other stairs/elevator down.

### Offices:

- 1030 A **Bodary, Kincaid**
- 1030 C **Bruggeman**
- 1040 C **Hunt**
- 1040 D **Ralph**
- 1040 E **Flick**

### Other:

- 1030 **Faculty Work Stn.**
- 1040 C **Kin-Help**

# Offices and Labs

## 1200 Level (north basement) CCRB

Back to Start



Annex

4000 CCRB	4000 Kinesiology
3000 CCRB	3000 Kinesiology
2000 CCRB	Bell Pool
1200	1000

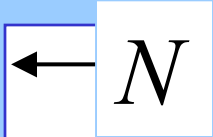

**Offices:**

- 1209 Boluyt
- 1211 A Hwang
- 1220 A Fogleman, Wuorinen
- 1236 Anguera, Walsh
- 1238 Crane, Knuth, Schenk
- 1256 Vincent
- 1271 Kao, Russell
- 1271 A Winkelseth
- 1271 B Barkowitz, Domingo, Huang
- 1271 C Goble, Gordon, Sawicki
- 1271 F Caviston
- 1273 Harber, Mear

---

**U-Move Fitness & KidSport:**

- 1256 Main Office
- 1260 Weight Room

---

**Classrooms:**

- 1240 Anatomy Lab
- 1250 Teaching Lab

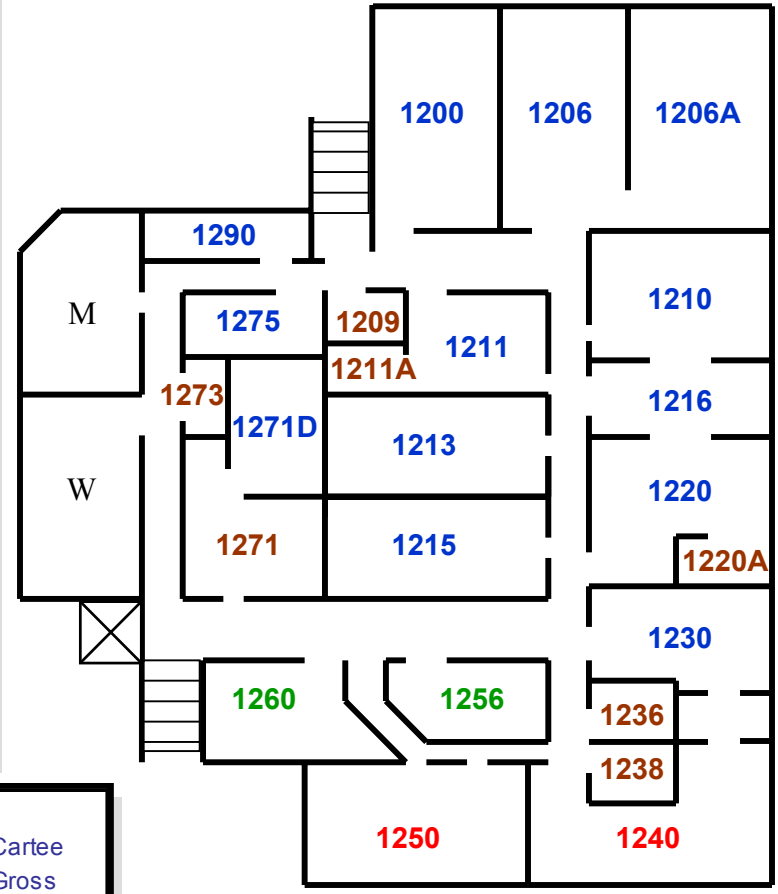

**Laboratories:**

1200	Muscle Biology Lab	Cartee
1206	Movement Dynamics Lab	Gross
1206 A	Human Neuromechanics Lab	Ferris
1210	Substrate Metabolism Lab	Horowitz
1211, 1290	Lab. Of Molecular Kinesiology	Boluyt
1213	Neuromuscular Research Lab	Palmieri
1215	Neuromotor Behavior Lab	Seidler
1220	Exercise Endocrinology Lab	Borer
1230	Curriculum and Instruction Lab	Chen

**The CCRB has two ground levels: the 1000 (south) area, and the 1200 (north) area.**

To get from one to the other, take the stairs or elevator to the 2000 level, go down the hall, and take the other stairs/elevator down.

# Classrooms

## 2000 Level CCRB

Back to Start



4000 CCRB	4000 Kinesiology
3000 CCRB	3000 Kinesiology
2000 CCRB	Bell Pool
1200	1000

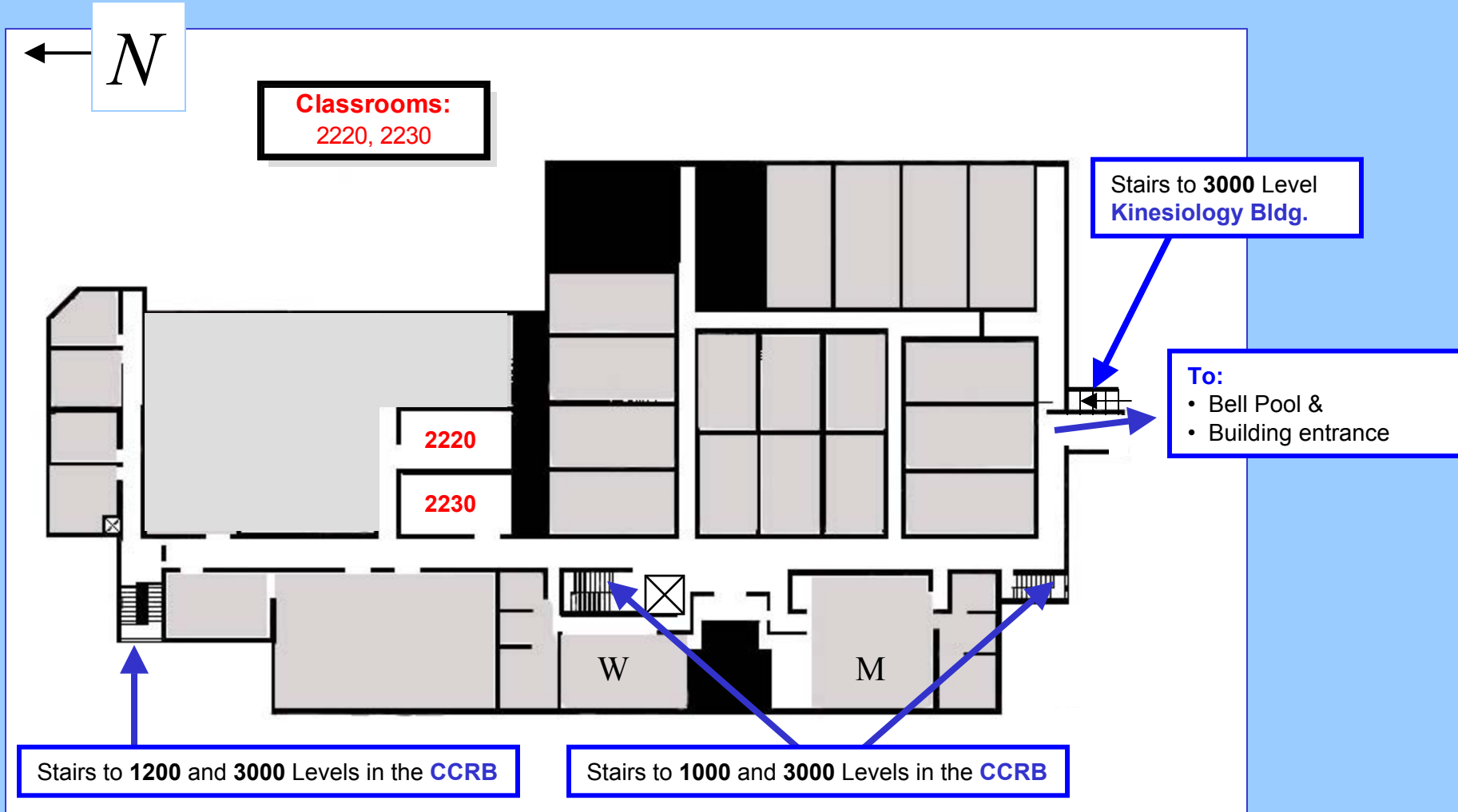

# Classrooms and Faculty Offices

## 3000 Level CCRB

Back to Start



Annex

4000 CCRB	4000 Kinesiology
3000 CCRB	3000 Kinesiology
2000 CCRB	Bell Pool
1200	1000

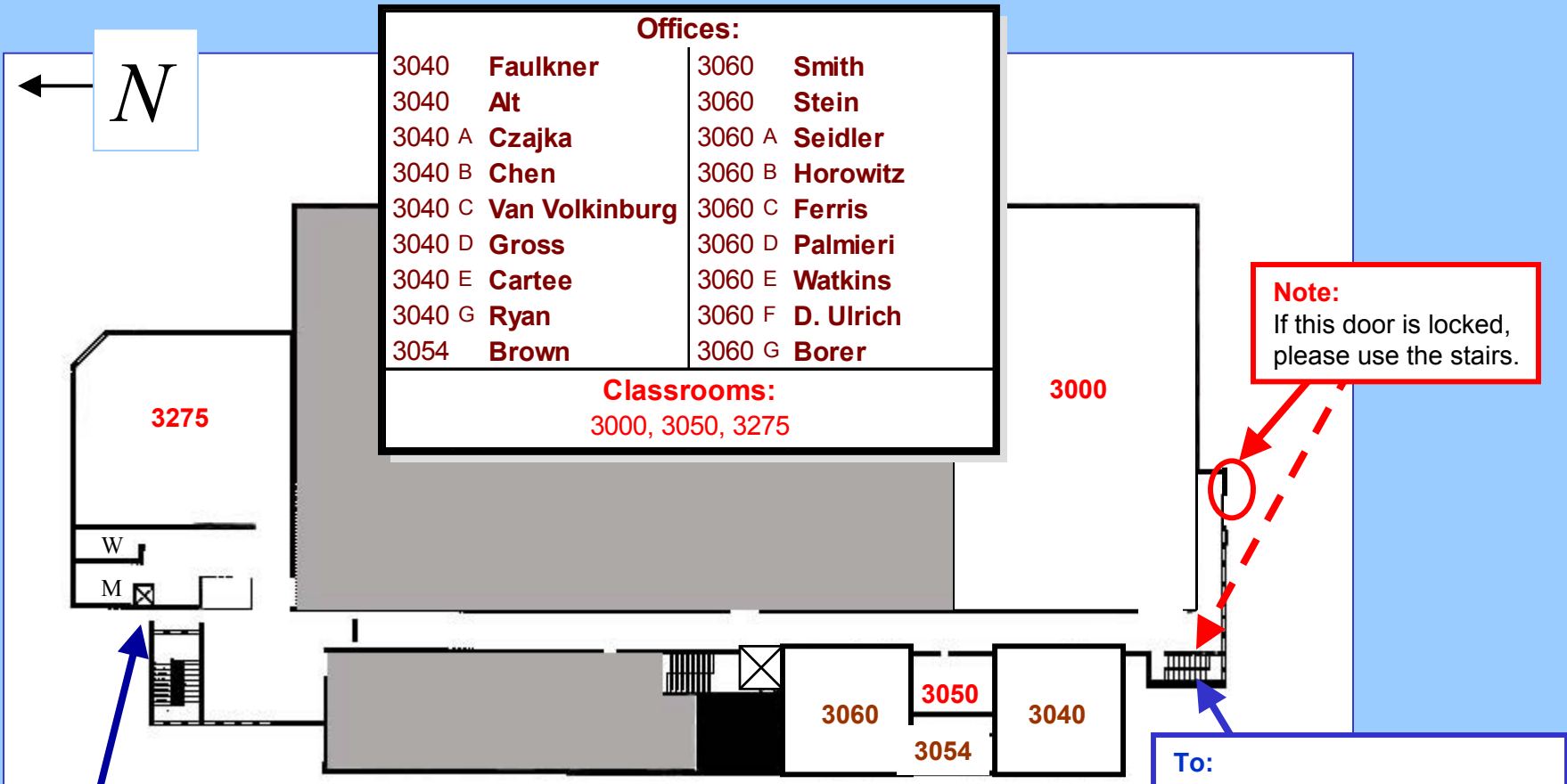

**Note:**  
If this door is locked,  
please use the stairs.

**CCRB  
Building Entrance**  
("bridge" or "north" entrance)

**To:**

- OSS
- Classrooms 3733, 3735 (Bickner Aud.), and 3741
- 4<sup>th</sup> Floor

Use stairwell to the 2<sup>nd</sup> floor, turn right and go towards Bell Pool. Climb those stairs to the 3<sup>rd</sup> floor.

# Classrooms, Office of Student Services

## 3000 Level Kinesiology Building

Back to Start



Annex

4000 CCRB	4000 Kinesiology
3000 CCRB	3000 Kinesiology
2000 CCRB	Bell Pool
1200	1000

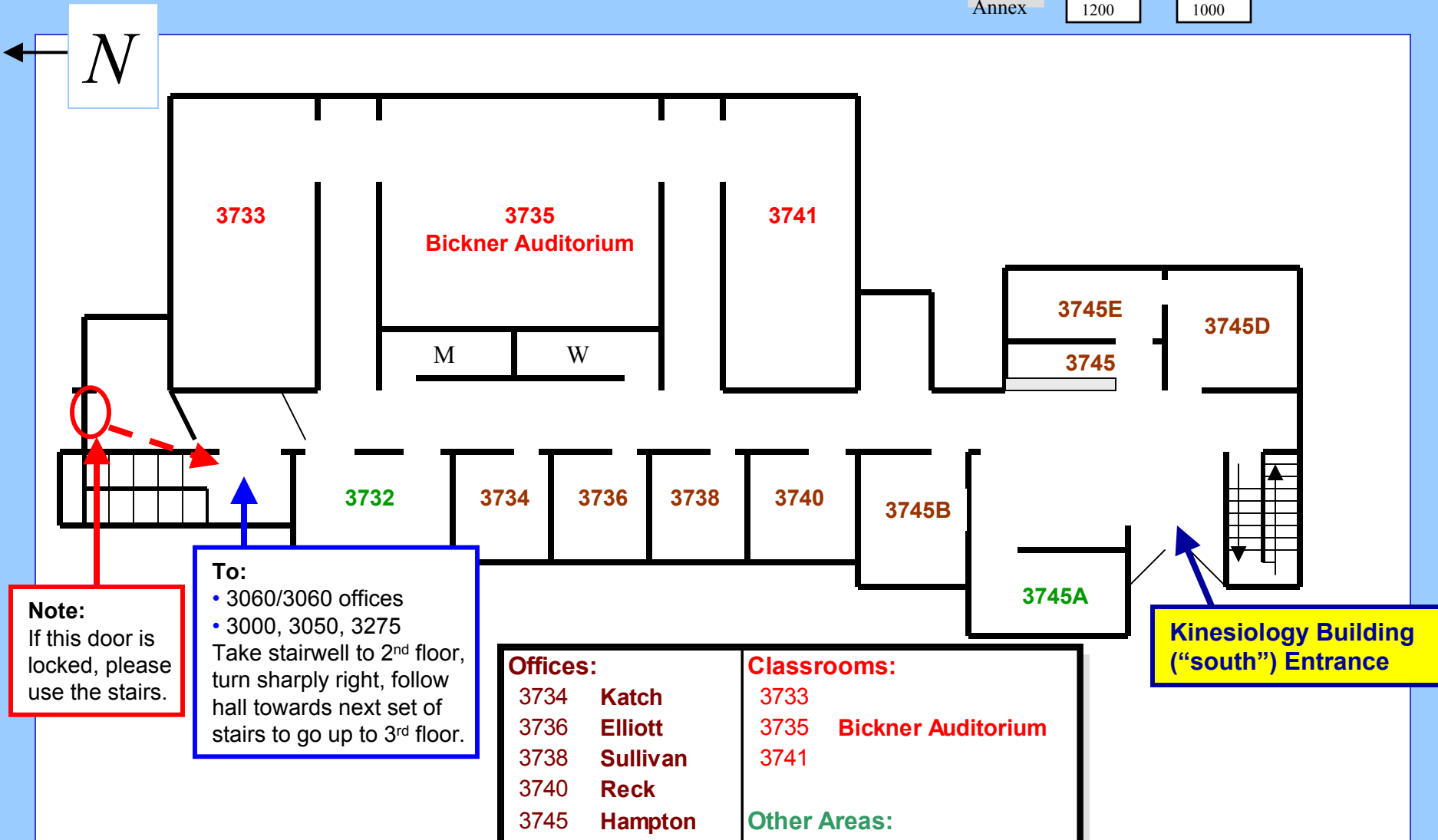

**Note:**  
If this door is locked, please use the stairs.

**To:**

- 3060/3060 offices
- 3000, 3050, 3275

Take stairwell to 2<sup>nd</sup> floor, turn sharply right, follow hall towards next set of stairs to go up to 3<sup>rd</sup> floor.

<b>Offices:</b>	<b>Classrooms:</b>
3734 <b>Katch</b>	3733
3736 <b>Elliott</b>	3735 <b>Bickner Auditorium</b>
3738 <b>Sullivan</b>	3741
3740 <b>Reck</b>	
3745 <b>Hampton</b>	<b>Other Areas:</b>
3745 B <b>Knapp</b>	3732 <b>Student Lounge</b>
3745 D <b>Kovacs</b>	3745 A <b>Career Resource Ctr</b>
3745 E <b>Israel</b>	

**Kinesiology Building ("south") Entrance**

# Labs & Administrative Offices

## 4000 Level Kinesiology Building

Back to Start



4000 CCRB	4000 Kinesiology
3000 CCRB	3000 Kinesiology
2000 CCRB	Bell Pool
1200	1000

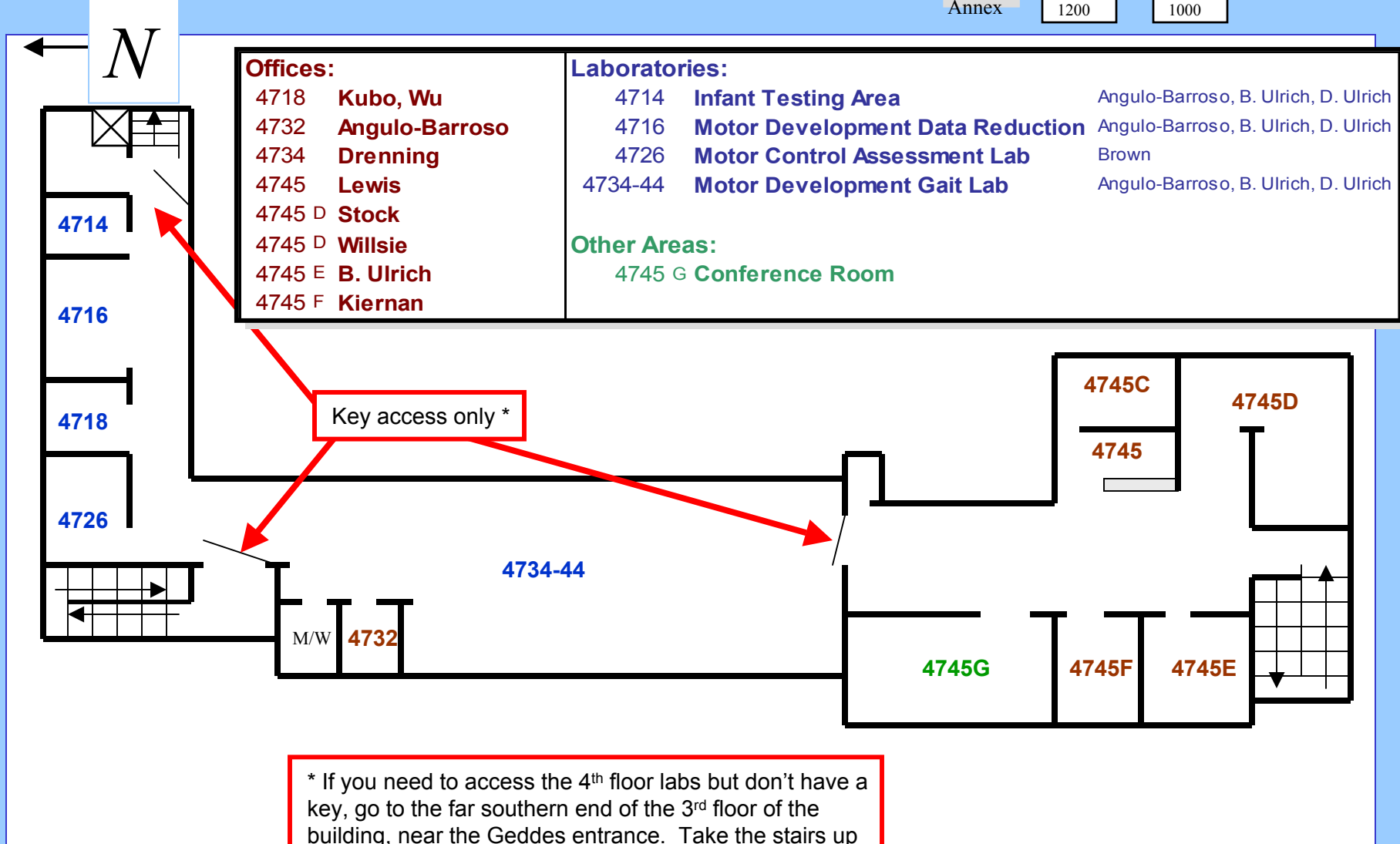

\* If you need to access the 4<sup>th</sup> floor labs but don't have a key, go to the far southern end of the 3<sup>rd</sup> floor of the building, near the Geddes entrance. Take the stairs up to the 4<sup>th</sup> floor office area, where the Executive Assistant can let you in.

# Offices and Labs

## The Annex (1327 Geddes)

Back to Start



4000 CCRB	4000 Kinesiology
3000 CCRB	3000 Kinesiology
2000 CCRB	Bell Pool
1200	1000

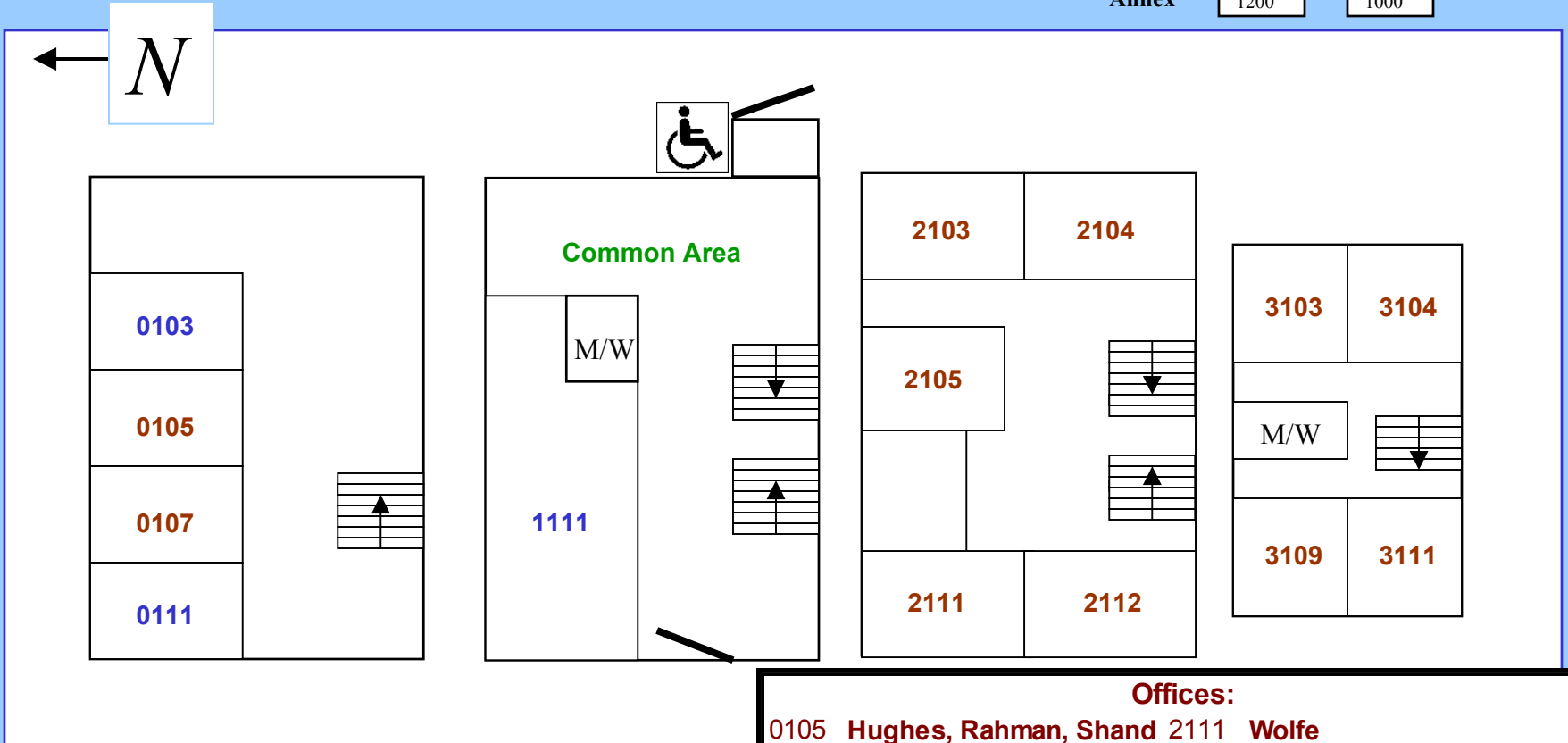

The Annex (next door east from the Kinesiology Bldg.) is wheelchair accessible via the back entrance. There is no elevator in this building.

Offices:	
0105 Hughes, Rahman, Shand	2111 Wolfe
2103 Moore	3103 Basten
2104 Winfree	3104 George
2105 Babiak	3109 Donahue, Hultgren, Nichols
	3111 Luker, Pollick
Labs:	
0103 Marketing Research Lab	Moore
0111 Michigan Center for Sport Management	Wolfe, Moore
1111 Center for Motor Behavior In Down Syndrome	
D. Ulrich, B. Ulrich, R. Angulo-Barroso	