

NOVEMBER 7, 2000

For Additional Information, Contact:

DEE BROWN

MARION COUNTY SUPERVISOR OF ELECTIONS
 Post Office Box 289
 Ocala, Florida 34478-0289

VOTING INSTRUCTIONS

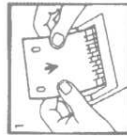

STEP 1. Using both hands, insert the ballot card all the way into the Votomatic.



STEP 2. Be sure the two slots in the end of your card fit down over the 2 red pins.

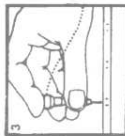

STEP 3. To vote, hold the punching stylus straight up. Punch straight down through the ballot card for the candidates, or issues of your choice.

DO NOT USE PEN OR PENCIL.

STEP 4. You may vote all pages.

STEP 5. After voting, remove the ballot card from the Votomatic. Turn ballot card over and remove any small "chips" that may be attached to back of card. Fold top of ballot card down over voted portion and place in ballot box.

NOTE: If you make a mistake, return your ballot card and obtain another.

GENERAL ELECTION MARION COUNTY, FLORIDA NOVEMBER 7, 2000

FEDERAL

ELECTORS FOR PRESIDENT AND VICE PRESIDENT

Vote for One
GEORGE W. BUSH for PRESIDENT

STATE	
TREASURER Vote for One	
TOM GALLAGHER (REP)	42
JOHN COSGROVE (DEM)	43
COMMISSIONER OF EDUCATION Vote for One	
CHARLIE CRIST (REP)	44
GEORGE H. SHELDON (DEM)	45
VASSILIA GAZETAS (NPA)	46
LEGISLATIVE	
STATE SENATOR DISTRICT 5 Vote for One	
BOB CASEY (REP)	48
ROD SMITH (DEM)	49
<i>To vote for a write-in candidate, follow the directions on the long stub of your ballot card.</i>	
STATE SENATOR DISTRICT 11 Vote for One	
ANNA COWIN (REP)	51
LESLIE SCALES (DEM)	52
STATE REPRESENTATIVE DISTRICT 10 Vote for One	
SUNNY CAROL PHILLIPS (REP)	53
WILL S. KENDRICK (DEM)	55
STATE REPRESENTATIVE DISTRICT 21 Vote for One	
JOE H. PICKENS (REP)	62
SKEET ALFORD (DEM)	63
STATE REPRESENTATIVE DISTRICT 22 Vote for One	
CHUCK CLEMONS (REP)	64
PERRY C. MCGRIFF, JR. (DEM)	65
PHIL A. DENTON (REP)	66
STATE REPRESENTATIVE DISTRICT 23 Vote for One	

COUNTY	
COUNTY COMMISSIONER DISTRICT 1 Vote for One	
R. A. "ANDY" KESSELING (REP)	86
PATRICIA E. NICHOLSON (DEM)	87
COUNTY COMMISSIONER DISTRICT 3 Vote for One	
PARNELL TOWNLEY (REP)	88
ED RANCOURT (DEM)	89
COUNTY COMMISSIONER DISTRICT 5 Vote for One	
STEVE HENNING (REP)	90
TERI CAREY (DEM)	91
SUPREME COURT	
Shall Judge R. FRED LEWIS of the Supreme Court be retained in office?	YES 98 NO 99
Shall Judge BARBARA J. PARIENTE of the Supreme Court be retained in office?	YES 100 NO 101
Shall Judge PEGGY A. QUINCE of the Supreme Court be retained in office?	YES 102 NO 103
DISTRICT COURT OF APPEAL	
Shall Judge EMERSON R. THOMPSON, JR., of the 5th District Court of Appeal be retained in office?	YES 106 NO 107
PROPOSED CONSTITUTIONAL AMENDMENTS OR OTHER PUBLIC MEASURES	
NO. 1 CONSTITUTIONAL AMENDMENT ARTICLE X, SECTION 19 (Initiative)	
Florida Transportation Initiative for statewide high speed monorail, fixed guideway or magnetic levitation system.	
To reduce traffic and increase travel alternatives, this amendment provides for development of a high speed monorail, fixed guideway or magnetic levitation system linking Florida's five largest urban areas and providing for access to existing air and ground transportation facilities and services by directing the state and/or state authorized private entity to implement the financing, acquisition of right-of-way, design, construction and operation of	

OFFICIAL BALLOT, GENERAL ELECTION
BROWARD COUNTY, FLORIDA
NOVEMBER 7, 2000

NOVEMBER 7, 2000

PAGE NO. 1

GENERAL ELECTION	
ELECTORS FOR PRESIDENT AND VICE PRESIDENT	
PRESIDENT AND VICE PRESIDENT (Vote for ONE Group)	
GEORGE W. BUSH - For PRESIDENT DICK CHENEY - For VICE PRESIDENT	REPUBLICAN 2
AL GORE - For PRESIDENT JOE LIEBERMAN - For VICE PRESIDENT	DEMOCRATIC 3
HARRY BROWNE - For PRESIDENT ART OLIVIER - For VICE PRESIDENT	LIBERTARIAN 4
RALPH MADER - For PRESIDENT WINDMA LADUKE - For VICE PRESIDENT	GREEN 5
JAMES HARRIS - For PRESIDENT MARGARET TROWE - For VICE PRESIDENT	SOCIALIST WORKERS 6
JOHN HAGELIN - For PRESIDENT MAT GOLDBABER - For VICE PRESIDENT	NATURAL LAW 7
PAT BUCHANAN - For PRESIDENT EZOLA FOSTER - For VICE PRESIDENT	REFORM 8
DAVID MCREYNOLDS - For PRESIDENT MARY CAL HOLLIS - For VICE PRESIDENT	SOCIALIST 9
HOWARD PHILLIPS - For PRESIDENT J. CURTIS FRAZIER - For VICE PRESIDENT	CONSTITUTION 10
MONICA MOOREHEAD - For PRESIDENT GLORIA LA RIVA - For VICE PRESIDENT	WORKERS WORLD 11
To vote for a write-in candidate, follow directions on the grey envelope.	

CONGRESSIONAL	
UNITED STATES SENATOR (Vote for ONE)	
BILL MCCOLLUM	REPUBLICAN 20
BILL NELSON	DEMOCRAT 21
JOE SIMONETTA	NATURAL LAW 22
JOEL DECKARD	REFORM 23
WILLIE LOGAN	NO PARTY 24
ANDY MARTIN	NO PARTY 25
DARRELL L. MCCORMICK	NO PARTY 26
To vote for a write-in candidate, follow directions on the grey envelope.	
REPRESENTATIVE IN CONGRESS 19TH CONGRESSIONAL DISTRICT (Vote for ONE)	
MORRIS KENT THOMPSON	REPUBLICAN 29
ROBERT WEXLER	DEMOCRAT 30
REPRESENTATIVE IN CONGRESS 20TH CONGRESSIONAL DISTRICT (Vote for ONE)	
PETER DEUTSCH	DEMOCRAT 31
To vote for a write-in candidate, follow directions on the grey envelope.	

CONGRESSIONAL	
REPRESENTATIVE IN CONGRESS 22ND CONGRESSIONAL DISTRICT (Vote for ONE)	
CLAY SHAW	REPUBLICAN 33
ELAINE BLOOM	DEMOCRAT 34
To vote for a write-in candidate, follow directions on the grey envelope.	
REPRESENTATIVE IN CONGRESS 23RD CONGRESSIONAL DISTRICT (Vote for ONE)	
BILL LAMBERT	REPUBLICAN 36
ALCEE L. HASTINGS	DEMOCRAT 37
To vote for a write-in candidate, follow directions on the grey envelope.	
S T A T E	
STATE TREASURER AND INSURANCE COMMISSIONER (Vote for ONE)	
TOM GALLAGHER	REPUBLICAN 40
JOHN COSGROVE	DEMOCRAT 41
COMMISSIONER OF EDUCATION (Vote for ONE)	
CHARLIE CRIST	REPUBLICAN 43
GEORGE H. SHELDON	DEMOCRAT 44
VASSILIA GAZETAS	NO PARTY 45

LEGISLATIVE	
STATE SENATOR 31ST SENATORIAL DISTRICT (Vote for ONE)	
DEBBY P. SANDERSON	REPUBLICAN 48
JOHN GILLESPIE	DEMOCRAT 49
STATE SENATOR 32ND SENATORIAL DISTRICT (Vote for ONE)	
KEN JENNING	REPUBLICAN 50
DEBBIE WASSERMAN SCHULTZ	DEMOCRAT 51
STATE REPRESENTATIVE 91ST HOUSE DISTRICT (Vote for ONE)	
CONNIE MACK	REPUBLICAN 52
KEVIN J. RADER	DEMOCRAT 53
STATE REPRESENTATIVE 92ND HOUSE DISTRICT (Vote for ONE)	
STEPHEN M. GREEP JR.	REPUBLICAN 54
JOHN P. 'JACK' SEILER	DEMOCRAT 55
STATE REPRESENTATIVE 96TH HOUSE DISTRICT (Vote for ONE)	
JOSEPH 'JOE' KAUFMAN	REPUBLICAN 56
STACY RITTER	DEMOCRAT 57
STATE REPRESENTATIVE 97TH HOUSE DISTRICT (Vote for ONE)	
ERIC E. GARNER	REPUBLICAN 59
NAN H. RICH	DEMOCRAT 60

OFFICIAL SAMPLE BALLOT
GENERAL ELECTION
HIGHLANDS COUNTY, FLORIDA
NOVEMBER 7, 2000

FEDERAL	
ELECTORS FOR PRESIDENT AND VICE PRESIDENT (A vote for the candidates will actually be a vote for their electors.) (Vote for ONE Group)	
GEORGE W. BUSH for PRESIDENT DICK CHENEY for VICE PRESIDENT	4
AL GORE for PRESIDENT JOE LIEBERMAN for VICE PRESIDENT	5
HARRY BROWNE for PRESIDENT ART OLIVIER for VICE PRESIDENT	6
RALPH NADER for PRESIDENT WINONA LA DUKE for VICE PRESIDENT	7
JAMES HARRIS for PRESIDENT MARGARET TROWE for VICE PRESIDENT	8
JOHN HAGELIN for PRESIDENT NAT GOLDHABER for VICE PRESIDENT	9
PAT BUCHANAN for PRESIDENT EZOLA FOSTER for VICE PRESIDENT	10
DAVID McREYNOLDS for PRESIDENT MARY CAL HOLLIS for VICE PRESIDENT	11
HOWARD PHILLIPS for PRESIDENT J. CURTIS FRAZIER for VICE PRESIDENT	12
MONICA MOOREHEAD for PRESIDENT GLORIA La RIVA for VICE PRESIDENT	13
To vote for a write-in candidate, follow the directions on the long stub of your ballot card.	

CONGRESSIONAL	
UNITED STATES SENATOR (Vote for ONE)	
BILL McCOLLUM (REP)	22
BILL NELSON (DEM)	23
JOE SIMONETTA (LAW)	24
JOEL DECKARD (REF)	25
WILLIE LOGAN (NPA)	26
ANDY MARTIN (NPA)	27
DARRELL L. McCORMICK (NPA)	28
To vote for a write-in candidate, follow the directions on the long stub of your ballot card.	
*REPRESENTATIVE IN CONGRESS, 12th CONGRESSIONAL DISTRICT (Vote for ONE)	
ADAM H. PUTNAM (REP)	31
MIKE STEDEM (DEM)	32
To vote for a write-in candidate, follow the directions on the long stub of your ballot card.	
*REPRESENTATIVE IN CONGRESS, 16th CONGRESSIONAL DISTRICT (Vote for ONE)	
MARK FOLEY (REP)	35
JEAN ELLIOTT BROWN (DEM)	36
JOHN McGUIRE (REF)	37
To vote for a write-in candidate, follow the directions on the long stub of your ballot card.	

STATE		
TREASURER (Vote for ONE)		
TOM GALLAGHER (REP)	42	
JOHN COSGROVE (DEM)	43	
COMMISSIONER OF EDUCATION (Vote for ONE)		
CHARLIE CRIST (REP)	45	
GEORGE H. SHELDON (DEM)	46	
VASSILIA GAZETAS (NPA)	47	
LEGISLATIVE		
*STATE REPRESENTATIVE, 77th HOUSE DISTRICT (Vote for ONE)		
JOSEPH R. SPRATT (REP)	49	
DORIS GENTRY (DEM)	50	
COUNTY		
CLERK OF THE CIRCUIT COURT (Vote for ONE)		
L. E. "LUKE" BROOKER (REP)	52	
CHARLES L. LAIRSEY (DEM)	53	
COUNTY COMMISSIONER DISTRICT 3 (Vote for ONE)		
ANDREW B. JACKSON (REP)	55	
J.D. BARRETT (NPA)	56	
TIM K. SCOTT (NPA)	57	
NONPARTISAN JUDICIAL		
JUSTICE OF THE SUPREME COURT		
Shall Justice R. FRED LEWIS of the SUPREME COURT be retained in office?	YES	62
	NO	63

HILLSBORO



FEDERAL		
ELECTORS FOR PRESIDENT AND VICE PRESIDENT (A vote for candidates will actually be a vote for their electors.) (Vote for ONE Group)		
GEORGE W. BUSH for PRESIDENT DICK CHENEY for VICE PRESIDENT	REPUBLICAN	3
AL GORE for PRESIDENT JOE LIEBERMAN for VICE PRESIDENT	DEMOCRAT	4
HARRY BROWNE for PRESIDENT ART OLIVIER for VICE PRESIDENT	LIBERTARIAN	5
RALPH NADER for PRESIDENT WINONA LaDUKE for VICE PRESIDENT	GREEN	6
JAMES HARRIS for PRESIDENT MARGARET TROWE for VICE PRESIDENT	SOCIALIST WORKERS	7
JOHN HAGELIN for PRESIDENT NAT GOLDHABER for VICE PRESIDENT	NATURAL LAW	8
PAT BUCHANAN for PRESIDENT EZOLA FOSTER for VICE PRESIDENT	REFORM	9
DAVID McREYNOLDS for PRESIDENT MARY CAL HOLLIS for VICE PRESIDENT	SOCIALIST	10
HOWARD PHILLIPS for PRESIDENT J. CURTIS FRAZIER for VICE PRESIDENT	CONSTITUTION	11
MONICA MOOREHEAD for PRESIDENT GLORIA LA RIVA for VICE PRESIDENT	WORKERS WORLD	12
WRITE-IN CANDIDATE		
UNITED STATES SENATOR (Vote for ONE)		
BILL McCOLLUM	REPUBLICAN	20
BILL NELSON	DEMOCRAT	21
JOE SIMONETTA	NATURAL LAW	22
JOEL DECKARD	REFORM	23
WILLIE LOGAN	NO PARTY	24
ANDY MARTIN	NO PARTY	25
DARRELL L. MCCORMICK	NO PARTY	26
WRITE-IN CANDIDATE		
CONGRESSIONAL		
REPRESENTATIVE IN		

STATE		
TREASURER (Vote for ONE)		
TOM GALLAGHER	REPUBLICAN	39
JOHN COSGROVE	DEMOCRAT	40
COMMISSIONER OF EDUCATION (Vote for ONE)		
CHARLIE CRIST	REPUBLICAN	42
GEORGE H. SHELTON	DEMOCRAT	43
VASSILIA GAZETAS	NO PARTY	44
STATE ATTORNEY THIRTEENTH JUDICIAL CIRCUIT (Vote for ONE)		
MARK OBER	REPUBLICAN	46
ROBERT SHIMBERG	DEMOCRAT	47
PUBLIC DEFENDER THIRTEENTH JUDICIAL CIRCUIT (Vote for ONE)		
ALAN SANDLER	REPUBLICAN	49
JULIANNE HOLT	DEMOCRAT	50

LEGISLATIVE		
STATE SENATOR DISTRICT 13 (Vote for ONE)		
VICTOR CRIST	REPUBLICAN	52
KATHY CASTOR	DEMOCRAT	53
STATE SENATOR DISTRICT 21 (Vote for ONE)		
RUDOLPH 'RUDY' BRADLEY	REPUBLICAN	54
LESLEY 'LES' MILLER	DEMOCRAT	55
KIM COLJOHN	NO PARTY	56
STATE REPRESENTATIVE DISTRICT 47 (Vote for ONE)		

LEGISLATIVE	
STATE REPRESENTATIVE DISTRICT (Vote for ONE)	
ED HOMAN	
SARA ROMEO	
STATE REPRESENTATIVE DISTRICT (Vote for ONE)	
KEN LITTLEFIELD	
LARRY McLAUGHLIN	
STATE REPRESENTATIVE DISTRICT (Vote for ONE)	
JOHNNIE B. BYRD, JR.	
JOHN WAYNE CLARK	
STATE REPRESENTATIVE DISTRICT (Vote for ONE)	
J D ALEXANDER	
WRITE-IN CANDIDATE	

COUNCIL	
CLERK OF THE CIRCUIT (Vote for ONE)	
BART H. SIEGEL	
RICHARD AKE	
SHERIFF (Vote for ONE)	
CAL HENDERSON	
WRITE-IN CANDIDATE	
PROFESSIONAL APPRAISER (Vote for ONE)	
ROB TURNER	
PAT HANNON	

1 A OFFICIAL BALLOT, GENERAL ELECTION
LEE COUNTY, FLORIDA
NOVEMBER 7, 2000

FEDERAL		
GEORGE W. BUSH for PRESIDENT	(REP)	4
DICK CHENEY for VICE PRESIDENT	(DEM)	5
AL GORE for PRESIDENT	(LIB)	6
HARRY BROWNE for PRESIDENT	(GRE)	7
ART OLIVIER for VICE PRESIDENT	(SWP)	8
RALPH MADER for PRESIDENT	(LAW)	9
WINONA LaDUKE for VICE PRESIDENT	(REF)	10
JAMES HARRIS for PRESIDENT	(SPF)	11
MARGARET TROME for VICE PRESIDENT	(CPF)	12
JOHN HAGELIN for PRESIDENT	(WWP)	13
NAT GOLDHABER for VICE PRESIDENT		14
PAT BUCHANAN for PRESIDENT		
EZOLA FOSTER for VICE PRESIDENT		
DAVID McREYNOLDS for PRESIDENT		
MARY CAL HOLLIS for VICE PRESIDENT		
HOWARD PHILLIPS for PRESIDENT		
J. CURTIS FRAZIER for VICE PRESIDENT		
MONICA MOOREHEAD for PRESIDENT		
GLORIA LaRIVA for VICE PRESIDENT		
To vote for a write-in candidate, follow the directions on the long stub of your ballot card.		

ELECTORS
FOR PRESIDENT
AND
VICE PRESIDENT
Vote for One Group

2 A OFFICIAL BALLOT, GENERAL ELECTION
LEE COUNTY, FLORIDA
NOVEMBER 7, 2000

CONGRESSIONAL		
BILL McCOLLUM	(REP)	22
BILL NELSON	(DEM)	23
JOE SIMONETTA	(LAW)	24
JOEL DECKARD	(REF)	25
WILLIE LOGAN	(NPA)	26
ANDY MARTIN	(NPA)	27
DARRELL L. McCORMICK	(NPA)	28
To vote for a write-in candidate, follow the directions on the long stub of your ballot card.		
PORTER GOSS	(REP)	32
SAM FARLING	(LAW)	33
To vote for a write-in candidate, follow the directions on the long stub of your ballot card.		

UNITED STATES
SENATOR
Vote for One

REPRESENTATIVE IN
CONGRESS, 14th
CONGRESSIONAL
DISTRICT
Vote for One

**GENERAL ELECTION
MARION COUNTY, FLORIDA
NOVEMBER 7, 2000**

FEDERAL

ELECTORS FOR PRESIDENT AND VICE PRESIDENT	
Vote for One	
GEORGE W. BUSH for PRESIDENT	3 (REP)
DICK CHENEY for VICE-PRESIDENT	4 (DEM)
JOE LIEBERMAN for VICE-PRESIDENT	5 (LIB)
HARRY BROWNE for VICE-PRESIDENT	6 (GRE)
WINONA LaDUKE for VICE-PRESIDENT	7 (SWP)
JAMES HARRIS for PRESIDENT	8 (LAW)
MARGARET TROWE for VICE-PRESIDENT	9 (REF)
NAT GOLDBERGER for VICE-PRESIDENT	10 (SPF)
PAT BUCHANAN for PRESIDENT	11 (CPF)
EZOLA FOSTER for VICE-PRESIDENT	12 (WWP)
DAVID MCREYNOLDS for PRESIDENT	
MARY CAL HOLLIS for VICE-PRESIDENT	
HOWARD PHILLIPS for PRESIDENT	
J. CURTIS FRAZIER for VICE-PRESIDENT	
MONICA MOOREHEAD for PRESIDENT	
GLORIA LA RIVA for VICE-PRESIDENT	
To vote for a write-in candidate, follow the directions on the long stub of your ballot card.	
CONGRESSIONAL	
UNITED STATES SENATOR	
Vote for One	
BILL MCCOLLUM	22 (REP)
BILL NELSON	23 (DEM)
JOE SIMONETTA	24 (LAW)
JOEL DECKARD	25 (REF)
WILLIE LOGAN	26 (NPA)
ANDY MARTIN	27 (NPA)
DARRELL L. MCCORMICK	28 (NPA)
To vote for a write-in candidate, follow the directions on the long stub of your ballot card.	
REPRESENTATIVE IN CONGRESS, 5TH CONGRESSIONAL DISTRICT	
Vote for One	

Florida Transportation Initiative for statewide high speed monorail, fixed guideway or magnetic levitation system.

To reduce traffic and increase travel alternatives, this amendment provides for development of a high speed monorail, fixed guideway or magnetic levitation system linking Florida's five largest urban areas and providing for access to existing air and ground transportation facilities and services by directing the state and/or state authorized private entity to implement the financing, acquisition of right-of-way, design, construction and operation of the system, with construction beginning by November 1, 2003.

YES For Approval	123
NO For Rejection	124

NO. 2 Local Option for Selection of Circuit Judges (Implementing Article V, Section 10)

Shall the method of selecting circuit court judges in the fifth judicial circuit be changed from election by a vote of the people to the selection by the judicial nominating commission and appointment by the Governor with subsequent terms determined by a retention vote of the people?

YES	127
NO	128

NO. 3 Local Option for Selection of County Judges (Implementing Article V, Section 10)

Shall the method of selecting county court judges in Marion County be changed from election by a vote of the people to the selection by the judicial nominating commission and appointment by the Governor with subsequent terms determined by a retention vote of the people?

YES	131
NO	132

SILVER SPRINGS SHORES	
SILVER SPRINGS SHORES TAX DISTRICT, ADVISORY COUNCIL	
Vote for Three	
CLARANA CALKINS	138
ABE CIMIJOITI	139
MAGNOLIA S.B. HODGES	140
RAYMOND F. POPEJOY	141
ENRIQUETA R. SCOTT	142
MABEL A. WALKER	143
PAUL WARBURTON	144

STATE REPRESENTATIVE DISTRICT 22	
Vote for One	
CHUCK CLEMONS	64 (REP)
PERRY C. MCGRIFF, JR.	65 (DEM)
PHIL A. DENTON	66 (REF)
STATE REPRESENTATIVE DISTRICT 23	
Vote for One	
ED JENNINGS, JR.	67 (DEM)
DICK WILLIAMS	68 (NPA)
STATE REPRESENTATIVE DISTRICT 24	
Vote for One	
DENNIS K. BAXLEY	69 (REP)
JUDY JOHNSON	70 (DEM)
STATE REPRESENTATIVE DISTRICT 25	
Vote for One	
CAREY BAKER	71 (REP)
RICK DWYER	73 (DEM)
STATE REPRESENTATIVE DISTRICT 42	
Vote for One	
HUGH GIBSON	74 (REP)
JOHN MARTIN	75 (DEM)
JOHN WAYNE SMITH	76 (LIB)
COUNTY	
SHERIFF	
Vote for One	
JOHN PAULS	80 (REP)
ED DEAN	81 (DEM)
SUPERINTENDENT OF SCHOOLS	
Vote for One	
JIM WARFORD	82 (REP)
HARRELL HARRISON	83 (DEM)
To vote for a write-in candidate, follow the directions on the long stub of your ballot card.	

THESE RACES WILL APPEAR ON ALL BALLOTS

CONGRESSIONAL	
BILL McCOLLUM (REP)	23
BILL NELSON (DEM)	24
JOE SIMONETTA (LAW)	25
JOEL DECKARD (REF)	26
WILLIE LOGAN (NPA)	27
ANDY MARTIN (NPA)	28
DARRELL L. McCORMICK (NPA)	29
WRITE-IN CANDIDATE To vote for a write-in candidate, follow directions on the secrecy envelope.	
UNITED STATES SENATOR (Vote for ONE)	

DAN MILLER (REP)	32
DANIEL E. DUNN (DEM)	33
WRITE-IN CANDIDATE To vote for a write-in candidate, follow directions on the secrecy envelope.	
REPRESENTATIVE IN CONGRESS 13TH CONGRESSIONAL DISTRICT (Vote for ONE)	

STATE	
TOM GALLAGHER (REP)	42
JOHN COSGROVE (DEM)	43
CHARLIE CRIST (REP)	44
GEORGE H. SHELDON (DEM)	45
VASSILIA GAZETAS (NPA)	46
COMMISSIONER OF EDUCATION (Vote for ONE)	
TREASURER AND INSURANCE COMMISSIONER (Vote for ONE)	

THIS RACE WILL APPEAR ON ALL BALLOTS

PRESIDENTIAL	
GEORGE W. BUSH - for President (REP)	3
DICK CHENEY - for Vice President (DEM)	4
AL GORE - for President (DEM)	5
JOE LIEBERMAN - for Vice President (LIB)	6
HARRY BROWNE - for President (GRE)	7
ART OLIVIER - for Vice President (SWP)	8
RALPH NADER - for President (LAW)	9
WINONA LaDUKE - for Vice President (REF)	10
JAMES HARRIS - for President (SPF)	11
MARGARET TROWE - for Vice President (CPF)	12
JOHN HAGELIN - for President (WWP)	
NAT GOLDHABER - for Vice President	
PAT BUCHANAN - for President	
EZOLA FOSTER - for Vice President	
DAVID McREYNOLDS - for President	
MARY CAL HOLLIS - for Vice President	
HOWARD PHILLIPS - for President	
J. CURTIS FRAZIER - for Vice President	
MONICA MOOREHEAD - for President	
GLORIA LA RIVA - for Vice President	
WRITE-IN CANDIDATE To vote for a write-in candidate, follow directions on the secrecy envelope.	
ELECTORS FOR PRESIDENT AND VICE PRESIDENT (A vote for the candidates will actually be a vote for their electors.) (Vote for ONE Group)	

OFFICIAL BALLOT, GENERAL ELECTION
PALM BEACH COUNTY, FLORIDA
NOVEMBER 7, 2000

3 →

(REPUBLICAN)
GEORGE W. BUSH, PRESIDENT
DICK CHENEY, VICE PRESIDENT

5 →

(DEMOCRATIC)
AL GORE, PRESIDENT
JOE LIEBERMAN, VICE PRESIDENT

7 →

(LIBERTARIAN)
HARRY BROWNE, PRESIDENT
ART OLIVIER, VICE PRESIDENT

9 →

(GREEN)
RALPH WADER, PRESIDENT
WINONA LADUKE, VICE PRESIDENT

11 →

(SOCIALIST WORKERS)
JAMES HARRIS, PRESIDENT
MARGARET TROWE, VICE PRESIDENT

13 →

(NATURAL LAW)
JOHN HAGELIN, PRESIDENT
MAT GOLDHABER, VICE PRESIDENT

ELECTORS
FOR PRESIDENT
AND
VICE PRESIDENT

(A vote for the candidates will
actually be a vote for their electors.)
(Vote for Group)

4 ←

(REFORM)
PAT BUCHANAN, PRESIDENT
EZOLA FOSTER, VICE PRESIDENT

6 ←

(SOCIALIST)
DAVID McREYNOLDS, PRESIDENT
MARY CAL HOLLIS, VICE PRESIDENT

8 ←

(CONSTITUTION)
HOWARD PHILLIPS, PRESIDENT
J. CURTIS FRAZIER, VICE PRESIDENT

10 ←

(WORKERS WORLD)
MONICA MOOREHEAD, PRESIDENT
GLORIA La RIVA, VICE PRESIDENT

WRITE-IN CANDIDATE
To vote for a write-in candidate, follow the
directions on the long stub of your ballot card.



OFFICIAL BALLOT
GENERAL AND MUNICIPAL ELECTION
DUVAL COUNTY, FLORIDA, NOVEMBER 7, 2000

ELECTORS
FOR PRESIDENT
AND
VICE PRESIDENT

(A vote for the candidate will actually
be a vote for their electors.)

(Vote for Group)

REPUBLICAN

GEORGE W. BUSH

For President

DICK CHENEY

For Vice President

3 →

DEMOCRATIC

AL GORE

For President

JOE LIEBERMAN

For Vice President

6 →

LIBERTARIAN

HARRY BROWNE

For President

ART OLIVIER

For Vice President

9 →

GREEN

RALPH NADER

For President

WINONA LaDUKE

For Vice President

12 →

SOCIALIST WORKERS

JAMES HARRIS

For President

MARGARET TROWE

For Vice President

15 →

**TURN PAGE FOR CONTINUED LIST OF CANDIDATES
FOR PRESIDENT AND VICE PRESIDENT**



OFFICIAL BALLOT
GENERAL AND MUNICIPAL ELECTION
DUVAL COUNTY, FLORIDA, NOVEMBER 7, 2000

ELECTORS
FOR PRESIDENT
AND
VICE PRESIDENT

(A vote for the candidate will actually
be a vote for their electors)

(Continued from previous page)

NATURAL LAW

JOHN HAGELIN

For President

NAT GOLDHABER

For Vice President

22 →

REFORM

PAT BUCHANAN

For President

EZOLA FOSTER

For Vice President

25 →

SOCIALIST

DAVID McREYNOLDS

For President

MARY CAL HOLLIS

For Vice President

28 →

CONSTITUTION

HOWARD PHILLIPS

For President

J. CURTIS FRAZIER

For Vice President

31 →

WORKERS WORLD

MONICA MOOREHEAD

For President

GLORIA LA RIVA

For Vice President

34 →

WRITE-IN CANDIDATE

For President

For Vice President

36 →